



FEATURES & SPECIFICATIONS

APPLICATION — The 2AF, is a 2-3/8" ID Adjustable Slip Fitter, designed to mount Techlight light fixtures onto a 2-3/8" OD tenon. It may be utilized with the majority of the Techlight product families (contact your sales associate for additional information). It may allow up to 180° adjustability on fixture being installed.

CONSTRUCTION — The heavy duty slip fitter is constructed of cast aluminum. Stainless steel hardware provided. Available with an integral button photocell for additional fixture control.

FINISH — Provided standard with our proprietary E-Coat pretreatment prior to the application of a powdercoat finish. The E-Coat delivers superior corrosion resistance and durability by creating a protective layer that penetrates any recessed areas or pits in the metal. After the E-Coat application a Super Durable Polyester powder coat finish is electrostatically applied in our state of the art paint facility. Standard colors available: Black, Bronze, US Green, White. Custom colors available upon request. This individual product carries a full 10-year finish warranty

Catalog Number	
Project	Type



Adjustable Slip Fitter 2AF

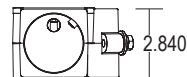
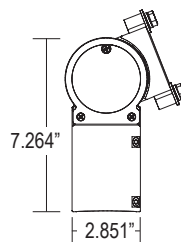

2AFPC with integral button photocell.

Series	Height	Length & Width
2AF	7.264"	2.851" x 2.840"

ORDERING INFORMATION

Choose the bold face options for the appropriate luminaire configuration for your application and enter on the line above each fixture attribute. Accessories may be factory installed, depending on the particular accessory chosen, but still be ordered as a separate line item.

2AF			
Series	Options	Finish	
2AF	Blank None PC Knuckle-Mount Button Photocell	BK Black BZ Bronze GR OD Green USG US Green WH White SP Special ²	

Example: **2AF-BZ**