



Catalog Number	
Project	Type

## FEATURES & SPECIFICATIONS

**APPLICATION** — The Bollard-SQ was built to be both decorative and functional. They can be used to light pathways and walkways to help direct pedestrian traffic. They can add value to the aesthetics of a building or structure.

**CONSTRUCTION** — The fixture is made with a durable extruded aluminum housing with overall height of 42". A clear polycarbonate lens protects the optical system.

**FINISH** — A Super Durable Polyester powder coat finish is electrostatically applied in our state of the art paint facility. Standard colors available: Black, Bronze, US Green, White. Custom colors available upon request.

**OPTICAL SYSTEM** — The fixture comes with an adjustable aluminum reflector that creates a symmetric light pattern. It reflects the light down and outward reducing light spillage.

**ELECTRICAL SYSTEM** — Available in 35W thru 100W pulse-start metal halide, and high pressure sodium. Comes standard with a 4KV pulse rated medium base socket. Each 60HZ CWA multi-tap ballast is mounted to an zinc plated steel ballast tray for easy installation.

**MOUNTING** — The bollard comes standard with a zinc base plate, three (3) 3/4" x 18" x 3" anchor bolts, and a rigid anchor bolt template. A centrally located wire entrance is provided. The housing is mounted to the base plate via flush mounting screws.



## Square Bollard BOL SERIES

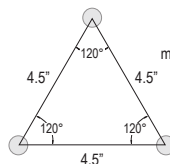
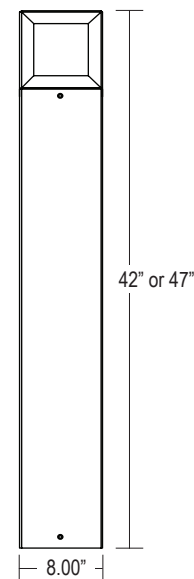

Bolt Pattern measures 4.5" bolt to bolt.

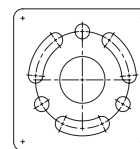

Anchor Bolts and Rigid Template may be pre-shipped at the customer's request.

Series	Housing Height	Length & Width
<b>BOL</b>	47"	8" x 8"

## ORDERING INFORMATION

Choose the bold face options for the appropriate luminaire configuration for your application and enter on the line above each fixture attribute. Accessories may be factory installed, depending on the particular accessory chosen, but still be ordered as a separate line item.

Example: **BOL 8S 42 100M MT BZ**

BOL							
Series	Type	Bollard Height	Wattage/Source		Voltage	Finish	
<b>BOL</b>	<b>8S</b> 8" Square	<b>42</b> 42"	<b>50M</b> 50W PS Metal Halide		<b>MT</b> Multi-Tap <sup>1</sup>	<b>BK</b> Black	
			<b>70M</b> 70W PS Metal Halide			<b>BZ</b> Bronze	
			<b>100M</b> 100W PS Metal Halide			<b>GR</b> US Green	
			<b>35S</b> 35W High Pressure Sodium			<b>WH</b> White	
			<b>50S</b> 50W High Pressure Sodium			<b>SP</b> Special <sup>2</sup>	
			<b>70S</b> 70W High Pressure Sodium				
			<b>100S</b> 100W High Pressure Sodium				
			<b>26F</b> 26W CFL				
			<b>32F</b> 32W CFL				
			<b>42F</b> 42W CFL				

### Accessories (Order as separate line items)

- PAB3418<sup>3</sup>** 3/4" x 18" x 3" Single Anchor Bolt
- PAB3418G<sup>3</sup>** 3/4" x 18" x 3" Single Galvanized Anchor Bolt
- PBLDTEMPLATE<sup>3</sup>** Rigid Anchor Bolt Template

### NOTES

- Multi-Tap is 120, 208, 240, 277V.
- Custom RAL color matching is available. Contact your Techlight sale representative for additional information.
- Specify three (3) PAB3418 or PAB3418G and one (1) PBLDTEMPLATE for pre-shipment of anchor bolts and template. Order one set per fixture ordered.