



Catalog Number	
Project	Type

FEATURES & SPECIFICATIONS

APPLICATION — The Genesis Gen2 line of LED Landscape Bullets are the most versatile LED fixtures on the market today. Various beam spreads and wattages allow for a customized finish to any property. The high end residential grade system was designed for low voltage operation residential applications.

CONSTRUCTION — The housing is made of compression molded fiber reinforced polyester composite. The color impregnated SR2 composite will not flake or peel. The LED light source is housed within a aluminum LED body with heat dissipating fins. An anti-siphon chamber is molded into the housing to keep internal electrical components from coming into contact with ground water. Multiple ring/guard assemblies are available for a customized finish.

OPTICAL SYSTEM — Techlight's proprietary OpticapSystem™ utilizes interchangeable optical lenses & reflectors to increase fixture lumen output efficiency. The system is provided with a high performance convex lenticular prismatic flood or a plano-convex spot optical lens. The flood & spot optical lenses are molded from low iron tempered glass. A 96% reflective UV stabilized injection molded reflector is included with each system. A variety of glass color filters are available to meet the designers specific color control needs. The composite guard rotates 360° for glare control.

ELECTRICAL SYSTEM — NOTE: A Techlight Surge Protector must be incorporated into the LED system at the beginning of each circuit as a minimum. Failure to do so will void the system warranty. Fixture operates at 9-16VAC or 9-24VDC input voltage. A 36 watt LED source provides approximately 1716 to 1831 (CW) Lumens of light.

TDB4W SERIES

Genesis Gen2 LV Large LED Burial Light



SERIES	HOUSING HEIGHT	DIAMETER
TDB4W	13.6"	12.2"

MOUNTING — Fixtures are designed to be in-ground burial lights and should be installed according to the installation instructions made available by Techlight. Proper drainage and substrate must be provided for water to flow freely through the well sleeve. A 3/4" conduit entry is supplied into the anti-siphon chamber of the housing. Concrete pour kits available (see Accessories).

LISTINGS — ETL listed for wet locations (IP67). Meets US and Canadian safety standards. -40°C to 40°C ambient operation.

ORDERING INFORMATION

Choose the bold face options for the appropriate luminaire configuration for your application and enter on the line above each fixture attribute. Accessories may be factory installed, depending on the particular accessory chosen, but still be ordered as a separate line item.

EXAMPLE:

TDB4W FL 36 NW LV CR CL

TDB4W						
SERIES	DISTRIBUTION	WATTAGE	COLOR TEMP	VOLTAGE	RING/GUARD	LENS
	FL = Flood (72°) SP = Spot (20°)	36 = 36W	CW = Cool White NW = Neutral White WW = Warm White	LV = 9-16VAC = 9-24VDC	CR = Composite Ring BR = Brass Ring SR = Stainless Steel Ring CG = Composite Guard	FL = Flat Lens CL = Convex Lens SL = Slip Resistant Lens

ACCESSORIES (Order as separate line items)

- BSP3-277-LC¹** 10kV Surge Protector
- PK4** Concrete Pour Kit
- TDB4AFD** TDB4W Anti Floatation Device

NOTES

- 1 = A Techlight Surge Protector must be incorporated into the LED system at the beginning of each circuit as a minimum. Failure to do so will void the system warranty.



TDB4W Genesis Gen2 LV Large LED Burial Light

AVAILABLE FIXTURE DIMENSIONS

Dimensions shown are for fixture bodies only. Mounting options must be ordered separately.

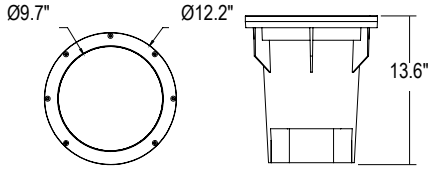

FIXTURE TRIM OPTIONS

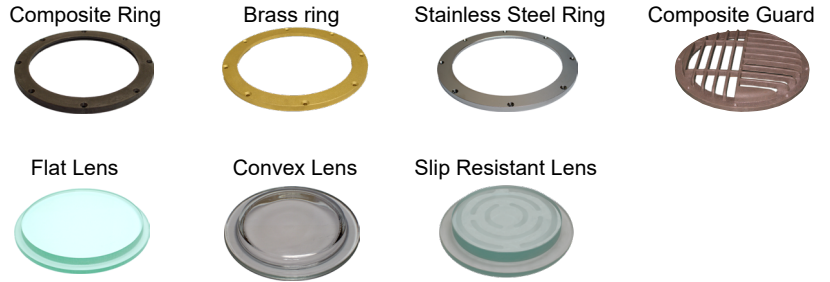

ADDITIONAL FIXTURE ACCESSORIES

GL2CAPCVXFLDREFL

72° Flood OpticapSystem™
Field Installable Flood Optic

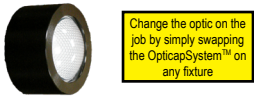

Change the optic on the job by simply swapping the OpticapSystem™ on any fixture

BSP3-277-LC¹

10kV Surge Protector



TDB4AFD

TDB4W Anti Floatation Device



LEDLFG120LENS

Green Glass Lens Filter (each)



PK4

Concrete Pour Kit



GL2CAPSPOPTREFL

20° Spot OpticapSystem™
Field Installable Spot Optic

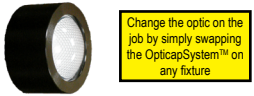

Change the optic on the job by simply swapping the OpticapSystem™ on any fixture

TLHB800RCH

Digital Timer



PSJ183

18 Gauge Lead Wire (Color Coded)



LEDLB120LENS

Blue Glass Lens Filter (each)



TRANSFORMERS



ELV300 300W AC Low Voltage Enclosure
ELV600 600W AC Low Voltage Enclosure
ELV900 900W AC Low Voltage Enclosure
ELV1200 1200W AC Low Voltage Enclosure

ELV300 thru ELV1200 are 120VAC-11-15VAC magnetic stepdown transformers. They have 11, 12, 13, 14, 15VAC outputs. The 600W, 900W, & 1200W units have 2ea, 3ea, & 4ea 300W rated output circuits respectively. They are enclosed in a aluminum NEMA raintight enclosure polyester powder coated BK finish.



ELV300MV24DCSS

300W DC Transformer in a Stainless Steel Enclosure

Output Voltage	Input Voltage Range	Output Current Range	Max. Output Power	Typical Efficiency (1)	Power Factor	
					110Vac	220Vac
24 Vdc	90 ~ 305 Vac	0 ~ 12.5 A	300W	91%	.99	.96



ELV500MV24DCSS

500W DC Transformer in a Stainless Steel Enclosure

Output Voltage	Input Voltage Range	Output Current Range	Max. Output Power	Typical Efficiency (1)	Power Factor	
					110Vac	220Vac
24 Vdc	175 ~ 305 Vac	0 ~ 20.83 A	500 W	94%	.99	.96



LVSS300 300W SS AC Low Voltage Enclosure
LVSS600 600W SS AC Low Voltage Enclosure
LVSS900 900W SS AC Low Voltage Enclosure
LVSS1200 1200W SS AC Low Voltage Enclosure

LVSS300 THRU LVSS1200 are 120VAC-11-15VAC magnetic stepdown transformers. They have 11, 12, 13, 14, 15VAC outputs. The 600W, 900W, & 1200W units have 2ea, 3ea, & 4ea 300W rated output circuits respectively. They are enclosed in a stainless steel NEMA raintight enclosure, with natural finish.

The **ELV150MV24DCSS** thru **ELV500MV24DCSS** are 120-277VAC – 24VDC electronic power supplies. They are equipped with surge protection, and are enclosed in a stainless steel NEMA raintight enclosure with natural finish. The data listed for these power supplies is correct. Just need to add the 150W version.

TDB4W Genesis Gen2 LV Large LED Burial Light

PERFORMANCE

ILLUMINANCE CONE DIAGRAMS

TDB4WFL36CWLV 36W TDB4W LED
Flood Optic Color Temperature: 5,900 K

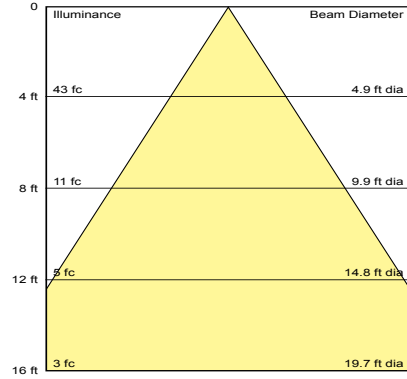

TDB4WFL36CWLV 36W TDB4W LED
Spot Optic Color Temperature: 5,900 K

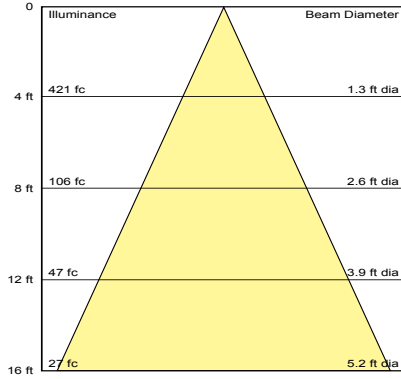

*Delivered lumens shown do not include light loss due to the fixture grill or lens.

Fixture	Color Temp	36W Lumen Output	
		FL	SP
TDB4W	CW (5900K)	1831	1716
	NW (4000K)	1658	1554
	WW (3000K)	1617	1515

WARNING: The driver assembly is wired and programmed specific to the unit configuration ordered. Any attempt to modify this unit will void the warranty.

