

Catalog Number

Project

Type

FEATURES & SPECIFICATIONS

APPLICATION — The TL Copper Path Light Series showcases a simple contemporary design with the sturdy construction of copper.

OPTICAL SYSTEM — TL frosted glass lens encompasses the light source to create an evenly diffused symmetrical light pattern. The TLSCPL comes with a 6.7" round cutoff flare top to keep light directed downwards. The TLPLKMC comes with a small cap top and directional side shield.

MOUNTING — Select 12" or 18" tall, ½" NPT stem and mounting stake. Provided with a 3' long 18 ga. whip and low voltage connector.

FINISH — The fixture is sold copper and will patina naturally over time.

TL SERIES

Copper Path Light

TLSCPL



TLPLKMC



ORDERING INFORMATION

Choose the bold face options for the appropriate luminaire configuration for your application and enter on the line above each fixture attribute. Accessories may be factory installed, depending on the particular accessory chosen, but still be ordered as a separate line item.

EXAMPLE:

TL PLKMC 18

TL				
SERIES	TOP	LENGTH	VOLTAGE	WATTAGE
	SCPL = 6.5" Flare Top PLKMC = 2" Directional Top	18 = 18" Stem 12 = 12" Stem	Blank = 12V	Blank = 20W



FIXTURE DIMENSIONS

ACCESSORIES (Order as separate line items)

TLSCPL

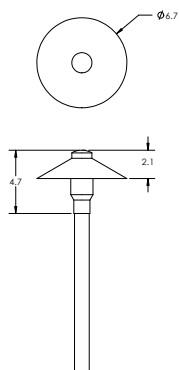

TLPLKMC

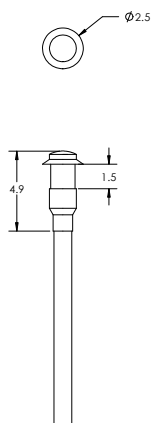

(See components section on the website for more transformer options)

LSSEB01 150W Transformer
LMSEB02 300W Transformer



PWW122LV 12 Gauge Low Voltage Cable
PWW102LV 10 Gauge Low Voltage Cable



TLHB800RCH Digital Timer



103137 LMP Led 4W BA155 12V 30K 90 CRI Clear



SMSB 12" x 1" Mounting Stake (Brass)
MMSB 18" x 1" Mounting Stake (Brass)
LMSB 20" x 2.5" Mounting Stake (Brass)



NOTE

JC20 12V Halogen Lamp Included. Other Lamps Available. (Consult TL Sales Representative)