



Catalog Number	
Project	Type

FEATURES & SPECIFICATIONS

APPLICATION — The high lumen output luminaire is designed to be a replacement for HID fixtures up to 1000W. It is optimal for lighting applications where long life, low maintenance, and consistent color rendering is required. Areas with limited accessibility due to fixture location or where heavy pedestrian or vehicle traffic makes maintenance difficult are ideal applications. The high wattage/lumen output allows the fixture to be used for parking, restaurant, quick service, shopping centers or sports lighting applications.

CONSTRUCTION — The heavy duty housing is constructed of die cast aluminum with heat dissipating fins. The optical assemblies are sealed in place using a silicone gasket for weather tight protection. Modular LED system for ease of maintenance. ETL listed for wet locations (IP65). Additional IP66 rating available upon request. Fixture can accommodate advanced wireless control, management and reporting systems for outdoor lighting.

FINISH — A corrosion-resistant epoxy coat layer that forms a uniform and all-encompassing protective barrier is applied to the fixtures prior to electrostatically applying a super durable polyester powder coat finish. Standard colors available: Black, Bronze, US Green, White. Custom colors available upon request.

OPTICAL SYSTEM — Made with a state of the art UV stabilized acrylic high performance refractive optical assemblies that use high transmittance materials to achieve precise photometric distributions. Available in Type V Narrow, V Medium, V Wide and Narrow Spot beam configurations. The full cutoff fixture is Star Light Friendly (meets or exceeds Dark Sky requirements) in the horizontal position.

ELECTRICAL SYSTEM — Available in up to a 4 module LED system in 5000K-70 CRI Cool White (+/- 500K) or 4000K-70 CRI Neutral White color temperatures. Consult factory for high CRI (90+) model availability. Available with 100-300V 50/60 Hz or 347V~480V. LED's rated for over 50,000 hours at 25°C

LSMA-X SERIES

High Lumen Output Scimitar LED Flood Light



SERIES	HOUSING HEIGHT	LENGTH & WIDTH
LSMA	5.23"	22.73" x 16.02"

ambient temperature. 0-10V dimming. Built-in surge protection up to 10 kV. Built-in Active PFC Function >95% Full load. LED Power Supply conforms to UL8750 standards.

MOUNTING — Standard mounting option is a (2AF) 2" Adjustable Slip Fitter. Additional mounting options, including a (B15) Trunnion Mount are available for custom applications.

LISTINGS — LED Power Supply listed for wet locations (IP65). Meets US and Canadian safety standards. -40°C to 50°C ambient operation. RoHS Compliant. Meets or exceeds DLC requirements.

ORDERING INFORMATION

Choose the bold face options for the appropriate luminaire configuration for your application and enter on the line above each fixture attribute. Accessories may be factory installed, depending on the particular accessory chosen, but still be ordered as a separate line item.

EXAMPLE:

LSMA 4 C X T5W F 1 BZ

LSMA								
SERIES	# OF MODULES	COLOR TEMP	# LED'S PER MODULE	OPTICS	DRIVE CURRENT	VOLTAGE	FINISH	OPTIONS
	1 = 1 Module 2 = 2 Module 4 = 4 Module	C = Cool White (5000K) N = Neutral White (4100K)	X = 8 XHP70 LED's	T5N = Type V Narrow T5M = Type V Medium T5W = Type V Wide	F = 1400 mA	1 = Multi-Volt ¹ 2 = 347~480V	BZ = Bronze BK = Black GR = US Green WH = White SP = Special ²	IP66 = Additional IP66 Fixture Rating B15 ⁵ = Trunnion Mount PC2 = 480V Twist-Lock Photocell PC6 ⁴ = Multi-Tap (105-285V) Twist-Lock Photocell PCR7 ⁴ = Twist-Lock Photocell Receptacle BTEC = Integrated Bluetooth Control Module Casambi Ready Mesh Network IMS ⁶ = Fixture Mount Passive Infrared Motion Sensor (IMS Lenses Below, Ordered Separately) TLWSFSP-L3 ⁷ = 360° lens, maximum coverage 40' diameter from 20' height (IMS) TLWSFSP-L7 ⁷ = 360° lens, maximum coverage 100' diameter from 40' height (IMS)

ACCESSORIES (Order as separate line items)

- SLSMA**⁸ Front Light Shield
- S213**³ Angeled Black Light Shield
- S237**⁸ Horizontal Shield
- S238**⁸ Vertical Shield
- S240**⁸ Three Sided Visor Shield
- S241**⁸ Three Sided Full Shield
- S242**⁸ Four Sided Shield

NOTES

- ¹ = Multi-Volt is an auto ranging power supply from 100V to 300V input.
- ² = Custom RAL color matching is available. Contact your sales representative for additional info.
- ³ = Order one per LED module. Field installed.
- ⁴ = Photocell Receptacle must be installed at the factory. No field installation.
- ⁵ = Ordering this option will replace the standard (2AF) 2" Adjustable Slip Fitter.
- ⁶ = TLWSFSP-L3 or L7 Lens must be ordered along with this sensor.
- ⁷ = Photo control shield available upon request. Len's must be ordered with IMS option.
- ⁸ = Available for 4 module only. Field installed.



LSMA-X High Lumen Output Scimitar LED Flood Light

AVAILABLE FIXTURE DIMENSIONS

Dimensions shown are for fixture bodies only. Mounting options must be ordered separately.

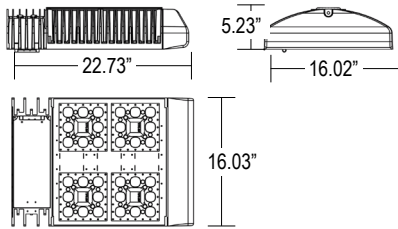

Dimensions shown for 4 Module Unit

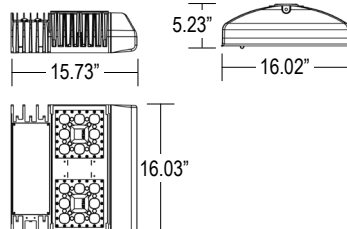

Dimensions shown for 2 Module Unit

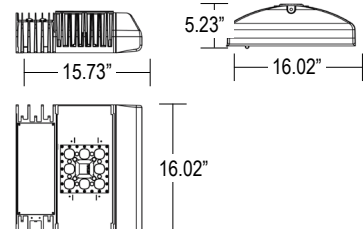

Dimensions shown for 1 Module Unit

FIXTURE & MOUNTING ACCESSORIES

2AF (Standard)
2" Adjustable Slip Fitter



B15⁵ (Option)
Trunnion Mount



S213³
Angled Back Light Shield

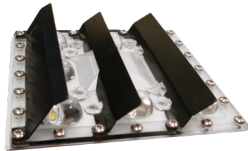

PCR7⁴
Twist-Lock Photocontrol Receptacle



PC2
480V Twist-Lock



PC6⁴
Multi-Tap (105-285V)
Twist-Lock Photocell

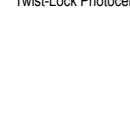

SLSMA⁸
Front Light Shield

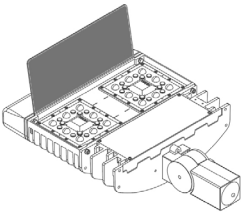

S237⁸
Horizontal Shield for 4 module

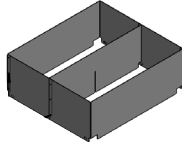

S238⁸
Vertical Shield for 4 module

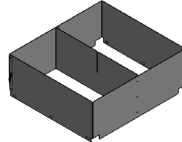

S240⁸
3 Sided Angled Shield for 4

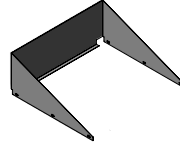

S241⁸
3 Sided Full Shield for 4 module

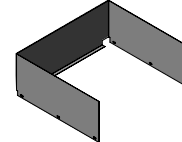

S242⁸
Four Sided Shield for 4 module

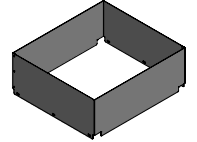

LUMINAIRE CHARACTERISTICS

1400 mA Drive Current

# of LED Modules	Drive Current	Color Temp	Delivered Lumens			System Wattage	L70 @ 25°C	Amperage Draw					
			TYPE 5N	TYPE 5M	TYPE 5W			120V	208V	240V	277V	347V	480V
1 Module	1400 mA	Cool White (5000K)	18165 B5 U0 G1	18352 B4 U0 G1	16474 B4 U0 G2	140	>50K	1.17 A	0.68 A	0.59 A	0.51 A	0.41 A	0.30 A
2 Module	1400 mA	Cool White (5000K)	36331 B5 U0 G2	36703 B5 U0 G1	32949 B5 U0 G4	280	>50K	2.34 A	1.35 A	1.17 A	1.02 A	0.81 A	0.59 A
4 Module	1400 mA	Cool White (5000K)	72661 B5 U0 G3	73407 B5 U0 G2	65897 B5 U0 G5	560	>50K	4.67 A	2.70 A	2.34 A	2.03 A	1.62 A	1.17 A
1 Module	1400 mA	Neutral White (4100K)	18165 B5 U0 G1	18352 B4 U0 G1	16474 B4 U0 G2	140	>50K	1.17 A	0.68 A	0.59 A	0.51 A	0.41 A	0.30 A
2 Module	1400 mA	Neutral White (4100K)	34933 B5 U0 G2	35292 B5 U0 G1	31681 B5 U0 G4	280	>50K	2.34 A	1.35 A	1.17 A	1.02 A	0.81 A	0.59 A
4 Module	1400 mA	Neutral White (4100K)	69867 B5 U0 G3	70583 B5 U0 G2	63363 B5 U0 G5	560	>50K	4.67 A	2.70 A	2.34 A	2.03 A	1.62 A	1.17 A

LSMA-X High Lumen Output Scimitar LED Flood Light

EPA RATINGS (ft²)

LSMA 1 & 2 (One & Two Module)

CATALOG NUMBER	DESCRIPTION	0°	20°	30°	45°	60°	70°	90°
TVA4/TVA5	Single Vertical Tenon	0.7	1.0	1.3	1.5	1.7	1.8	2.1
TV2	Two In-Line Tenons	2.2	3.0	3.4	3.9	4.2	4.4	5.1
TV3	Three In-Line Tenons	3.7	4.7	5.4	6.2	6.7	6.9	7.9
TV3120	Three Tenons at 120°	2.9	3.7	4.0	4.4	4.7	4.9	5.3
TV4	Four In-Line Tenons	5.1	6.5	7.4	8.4	9.1	9.4	10.8
TVC4	Four Tenons at 90°	3.7	4.5	5.0	5.5	5.8	6.0	6.7
BH2180	Two In-Line Tenons	1.7	2.5	2.9	3.4	3.7	3.9	4.6
BH3180	Three In-Line Tenons	2.7	3.7	4.4	5.2	5.7	5.9	6.9
BH3120	Three Tenons at 120°	2.5	3.2	3.6	4	4.3	4.4	4.8
BH4180	Four In-Line Tenons	3.7	5.2	6.1	7.1	7.7	8	9.5
BH490	Four Tenons at 90°	3.1	3.9	4.4	4.9	5.2	5.4	6.1

LSMA 4 (Four Module)

CATALOG NUMBER	DESCRIPTION	0°	20°	30°	45°	60°	70°	90°
TVA4/TVA5	Single Vertical Tenon	1	1.3	1.7	2.1	2.4	2.5	3.1
TV2	Two In-Line Tenons	2.8	3.5	4.2	5.1	5.6	5.9	7.1
TV3	Three In-Line Tenons	4.6	5.6	6.6	7.9	8.8	9.2	10.9
TV3120	Three Tenons at 120°	3.4	4.5	5	5.8	6.4	6.6	7.3
TV4	Four In-Line Tenons	6.3	7.6	9	10.7	11.9	12.4	14.7
BH2180	Two In-Line Tenons	2.3	3	3.7	4.6	5.1	5.4	6.6
BH3180	Three In-Line Tenons	3.6	4.6	5.6	6.9	7.8	8.2	9.9
BH3120	Three Tenons at 120°	3	4.1	4.5	5.3	5.9	6.2	6.8
BH4180	Four In-Line Tenons	5	6.3	7.7	9.4	10.6	11.1	13.4
BH490	Four Tenons at 90°	3.7	5.1	5.8	6.6	7.2	7.5	8.6



WARNING: Maintenance performed including the replacement of LED modules while power is still supplied to the luminaire may result in system failures and will void the warranty.



TECHLIGHT
INNOVATION IN ILLUMINATION

2707 SATSUMA | DR. DALLAS, TX 75229 | PH: 800.225.0727 | www.techlight.com