



Catalog Number	
Project	Type

FEATURES & SPECIFICATIONS

APPLICATION — Landscape Transformers supply low-voltage 12/13/14/15V power to various lighting fixtures, including landscape lighting, spotlights, path lights, outdoor lighting, garden lighting, swimming pool, lawn lighting, and spa lights. They are suitable for both residential and commercial applications, including submersible lighting fixtures.

CONSTRUCTION — These transformers feature a built-in encapsulated E-I core lamination design and are housed in a 304 stainless steel enclosure with gaskets to protect against water, dust, and pest intrusion. The housing includes a removable and lockable hinged door and bottom panel, ensuring durability and ease of access. The transformers are designed to operate efficiently with minimal energy consumption, ensuring long-term reliability.

MOUNTING — The transformers can be mounted on a wall or stanchion using the mounting tabs at the top and bottom. Installation is straightforward, thanks to the wiring compartment with multiple pre-punched knockouts and a replaceable rubber cover for cable connections. The color-coded wire markers further simplify maintenance and troubleshooting. Mount at least 1' above ground.

ELECTRICAL SYSTEM — Equipped with a 6' water-resistant power cable cord and plug, these transformers accept an input voltage of 120VAC at 50/60Hz. They offer multiple output voltage taps (12 VAC, 13 VAC, 14 VAC, 15 VAC) to compensate for voltage drop. The transformers include primary circuit protection with an automatic (auto reset) thermal breaker and secondary circuit protection with a 25A magnetic circuit breaker. The highly efficient E-I core operates cooler, generates less noise, and experiences minimal voltage loss under load. Optional features include a timer, wireless controls, or a photocell light sensor.

LISTINGS — These transformers are ETL Listed to US (UL1838) and Canada (CSA C22.2#250.7) safety

LVL 300 SERIES

Low Voltage Landscape Transformer 300 Watt (12v-15v) Multi-Tap



SERIES	LENGTH, WIDTH & HEIGHT
LVL300	12.00" x 6.00" x 5.38"

standards, ensuring they meet rigorous safety requirements. They are IP65 rated, providing protection against dust and water jet spray, making them suitable for both indoor and outdoor use. The transformers come with a 3-year warranty and are designed to operate in temperatures ranging from -20°C to 70°C, Class B.

WARRANTY — The complete luminaire is covered by a 3-year limited warranty.

ORDERING INFORMATION

Choose the bold face options for the appropriate luminaire configuration for your application and enter on the line above each fixture attribute. Accessories may be factory installed, depending on the particular accessory chosen, but still be ordered as a separate line item.

EXAMPLE:

LVL300

PART NUMBER	DESCRIPTIONS
LVL300	300W 120V Input Transformer Natural Stainless Steel Finish

DIMENSIONS

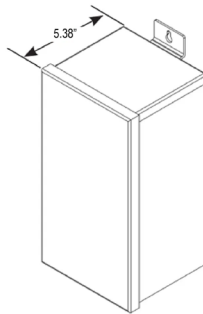
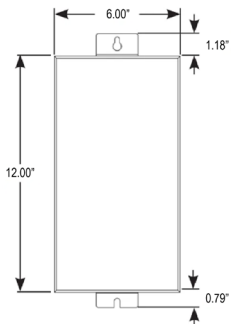

Input Voltage	120VAC, 60Hz
Output Voltage	12/13/14/15VAC
Max. Output Current	25A
Max. Total Wattage	300W

Suitable for use with submersible luminaires or submersible pumps

Dimmers Approved

Pool & Spa Rated



Risk of fire. If the installation involves running wiring through a building structure, special wiring methods are needed. Please consult a qualified electrician.



Risk of fire. DO NOT place insulation under terminal plate. Check connection after installation.

ACCESSORIES

TLTN111
Mechanical Timer



PSJ163
16 Gauge 3 Strand Lead Wire



PCCORD-6 6' Photocell Extension Cord
PCCORD-8 8' Photocell Extension Cord



P20000PC-LVENC
Photocell (DC Transformer Operation Only)



LVL300 w/ Timer and Photocell
Must be ordered separately

